

**Gammill
Catahoula Creek Tract
Sec 11, 12, 13, 24 T7S R16W
Hancock County, MS
Total Tax Acres ± 2,000
Total GIS Acres ± 2,050**

Legend

Planted Pine Mrch	Hardwood Branch	ROW
Natural Pine Mrch	Food Plot	Loading Deck
Clearcut	Brush	Road
		Water
		Pay-as-Cut

Sold (±522.8 GIS acres)
 Remainder (±1,527.7 GIS acres)

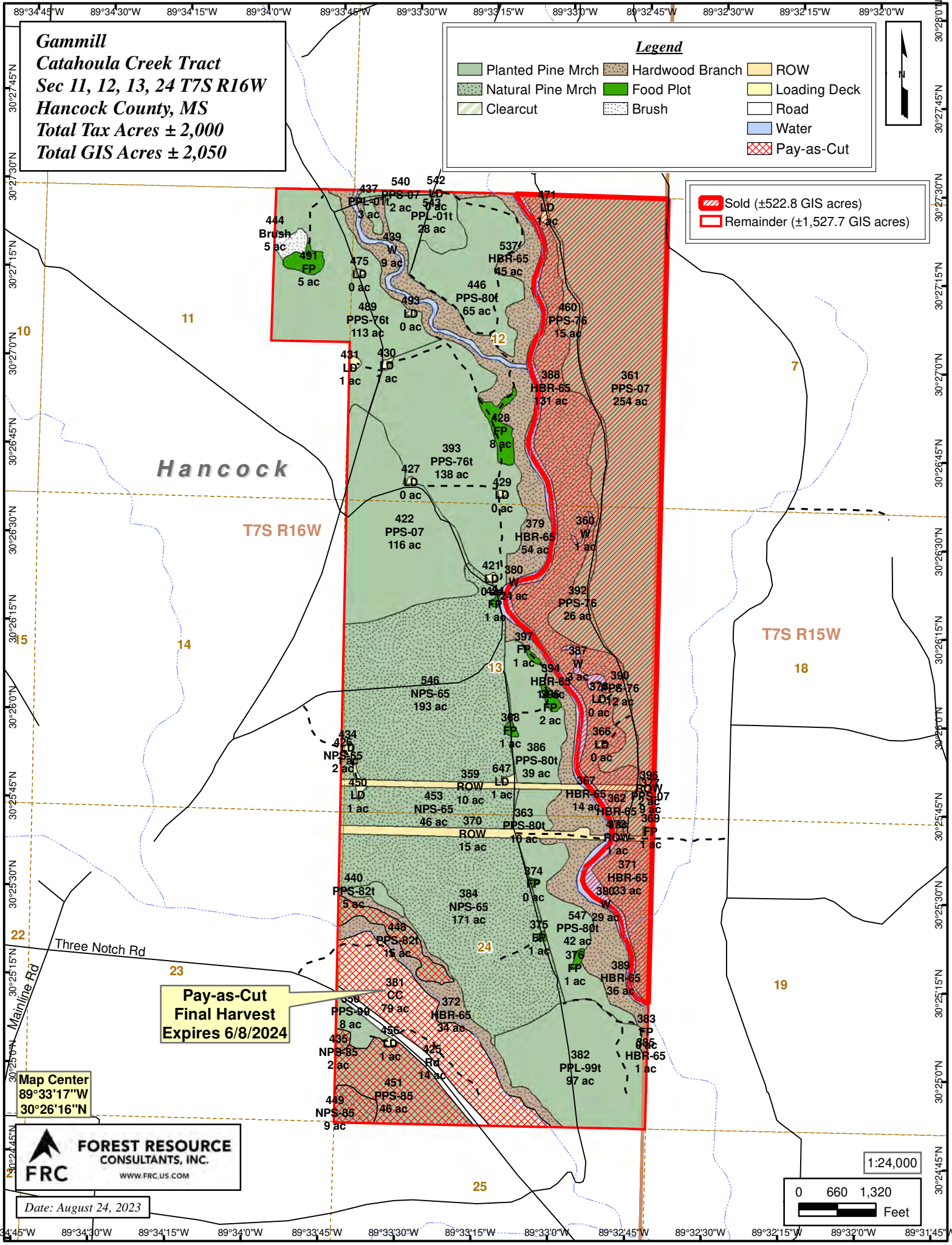

**Pay-as-Cut
Final Harvest
Expires 6/8/2024**

**Map Center
89°33'17"W
30°26'16"N**

FRC
**FOREST RESOURCE
CONSULTANTS, INC.**
 WWW.FRC.US.COM

Date: August 24, 2023

1:24,000
 0 660 1,320
 Feet